

Existing Ground Floor Plan
Scale 1:200

| Revision | Date | Description | Issued | Checked |
|----------|------------|---|--------|---------|
| P1 | 31.05.2024 | Part 8 Planning Application to Kildare County Council | AOD | DM |
| P2 | 04.06.2024 | Part 8 Planning Application Revisions | | |



Notes
Do not scale drawings. All dimensions should be checked on site. Errors to be reported to Architect. To be read in conjunction with all relevant Architect's services and engineers's drawings. Contractors, sub-contractors and suppliers must verify any critical dimensions on site prior to fabrication of any building element. Any discrepancies are to be reported to the Architect. This drawing should be read in conjunction with all relevant specifications, engineers and specialist consultant's information. Any discrepancies must be reported prior to installation.
No information in this drawing/specification should be interpreted as design related to fire safety or fire performance. As required by the Professional Indemnity market we exclude any liability whatsoever for the fire safety of buildings, products, materials or systems and assume these will be by others such as a Fire Engineer and Specialist Contractor Design.
Copyright
Copyright Metropolitan Workshop LLP
No implied license exists. This drawing should not be used to calculate areas for the purpose of valuation. Do not scale this drawing. All dimensions to be checked on site by the contractor and such dimensions to be their (their) responsibility. All work must comply with the relevant British Standards and Building Regulations. Drawing's error and omissions to be reported to the architect.
This drawing was prepared in part, based on survey information provided by others. Whilst this information is believed to be reliable, Metropolitan Workshop assumes no responsibility for the accuracy of this information or any errors or omissions that may have been incorporated into it as a result of incorrect information provided by others.

- Key**
- North Point
 - Existing Fabric
 - Existing Fabric to be Removed
 - Existing Hedgerow
 - Existing Hedgerow to be removed

- Building A1 - North Dovecot
- Building A2 - South Dovecot
- Building B1 - The Wonderful Barn
- Building B2 - Potat House
- Building C - Barnhall House
- Building D1 - East Stable
- Building D2 - West Stable
- Courtyard 1
- Courtyard 2
- Courtyard 3

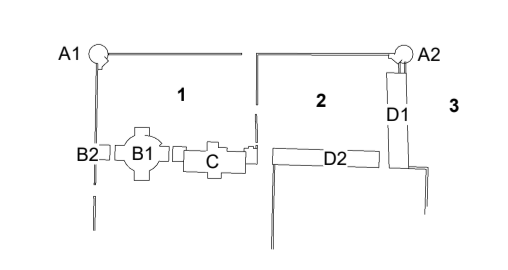

Metropolitan Workshop
Tower 2, Fumbally Lane, Dublin D08 N2N6
00 353 (0)1 531 4889
www.metwork.ie

| | | | | | | | | |
|-----------|----------------------------|--------|-------|------|------|-----------|-------------|----------|
| Project: | The Wonderful Barn | | | | | | | |
| Client: | Kildare County Council | | | | | | | |
| Location: | Leixlip, Co. Kildare | | | | | | | |
| Title: | Existing Ground Floor Plan | | | | | | | |
| Date: | 04.06.2024 | | | | | | | |
| Scale: | As indicated @ A1 | | | | | | | |
| Project | Originator | Volume | Level | Type | Role | Reference | Suitability | Revision |
| 2123 | MET | ZZ | ZZ | DR | A | 091001 | S4 | P2 |

MW BIM Suitability Codes: A1, A2, An, etc. - Approved and accepted as Stage Complete, B1, B2, Bn, etc. - Partially signed-off, CR - As Construction Record documentation, S0 - Initial status or WP, S1 - Suitable for Coordination, S2 - Suitable for Information, S3 - Suitable for Review & Comment, S4 - Suitable for Stage Approval, S5 - Suitable for PM Authorisation (Information Exchanges 1-5), S7 - Suitable for AM Authorisation (Information Exchange 6)